

Materials

1. Insulator: ABS, black
2. Pin: C3604 brass, 2 µm nickel plated
3. Shell: C3604 brass, 2 µm nickel plated

Electrical Requirements

Dielectric strength: 1 min @ 500 Vac
Insulation resistance: 100 MΩ @ 500 Vdc
Contact resistance: 30 mΩ or less

Mechanical Requirements

Insertion force: 0.3-3 kgf
Withdrawal force: 0.3-3 kgf
Life cycle: 5000 mating cycles while maintaining 0.3 kgf min.
insertion force, 0.2 kgf min. withdrawal force and less than
100 mΩ contact resistance.
Bending strength: ≥ 3.2 kg
Breaking strength: ≥ 6.8 kg

Environmental Requirements

Cold test: -25 ±3 °C for 48 hours without deformation
Heat test: 70 °C, relative humidity 70-85% for 96 hours
without deformation
Humidity test: 40 °C, relative humidity 90-100% for 96 hours
without deformation
Salt spray test: 35 °C, relative humidity 90-95%, 5% NaCl
mist for 24 hrs. Wash parts after test. Maintain mechanical
requirements and a contact resistance of less than 80 mΩ.

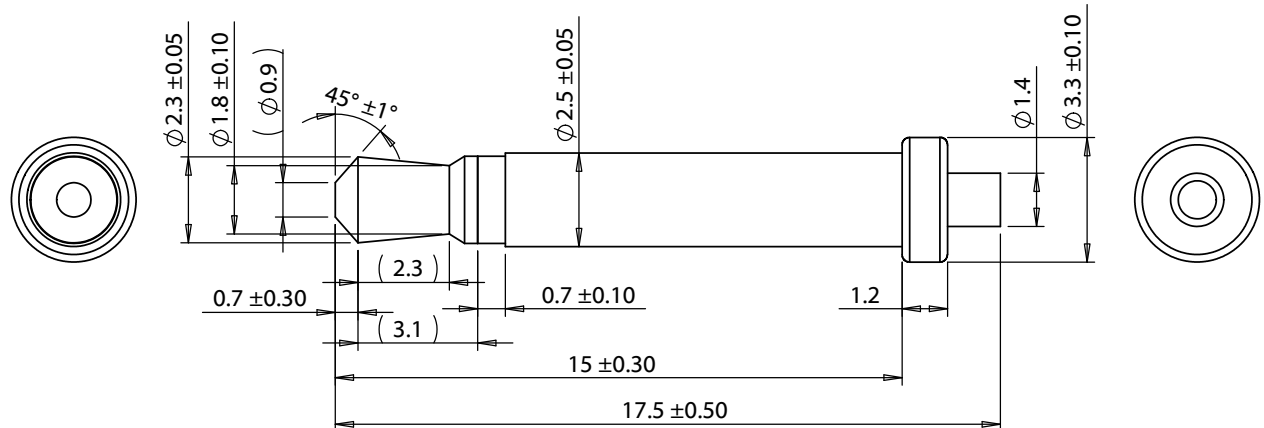
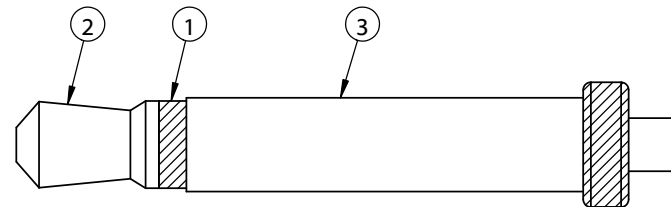

Revision:	Date:	Description:	Prepared:	Notes:	<h1>TENSILITY</h1> <p>tel 1.541.323.3228 800 877.670.7118 fax 1.541.323.4202 web tensility.com</p>		
A	1/4/2012	Initial release	Verified:	RoHS and REACH compliant			
A1	5/9/2014	Updated part	Dimensions are in millimeters. Tolerances: X: ± 0.5 mm X.X: ± 0.3 mm X.XX: ± 0.05 mm	Function test: no open, no short circuit, no intermittent	Size: Part number:		
A2	2/16/2016	Updated connector dimensioning		Description: Connector, mono plug 2.5x17.5 mm, brass nickel plated	A 50-00132		
A3	2/17/2017	Corrected connector dimensioning			Scale: 5:1		
					Sheet 1 of 1		