

| ITEM NO. | PART NUMBER | DESCRIPTION  | QTY. | COMPONENT NOTES    |
|----------|-------------|--|------|--------------------|
| 1        | 57-00002    | LED, Ø3x5.1 mm, green, InGaP, 2.2 V, 40°, 400 mcd                  | 1    |                    |
| 2        | 24-00385    | Overmold, LED panel  | 1    | Nylon PA201, black |
| 3        | 30-01777    | Wire, hook-up, TS, 26 AWG, UL 11028, 600V, 105C, 1 mm, mPPE, green | 1    |                    |
| 4        | 30-01773    | Wire, hook-up, TS, 26 AWG, UL 11028, 600V, 105C, 1 mm, mPPE, black | 1    |                    |

### Installation Details

Recommended panel cutout:

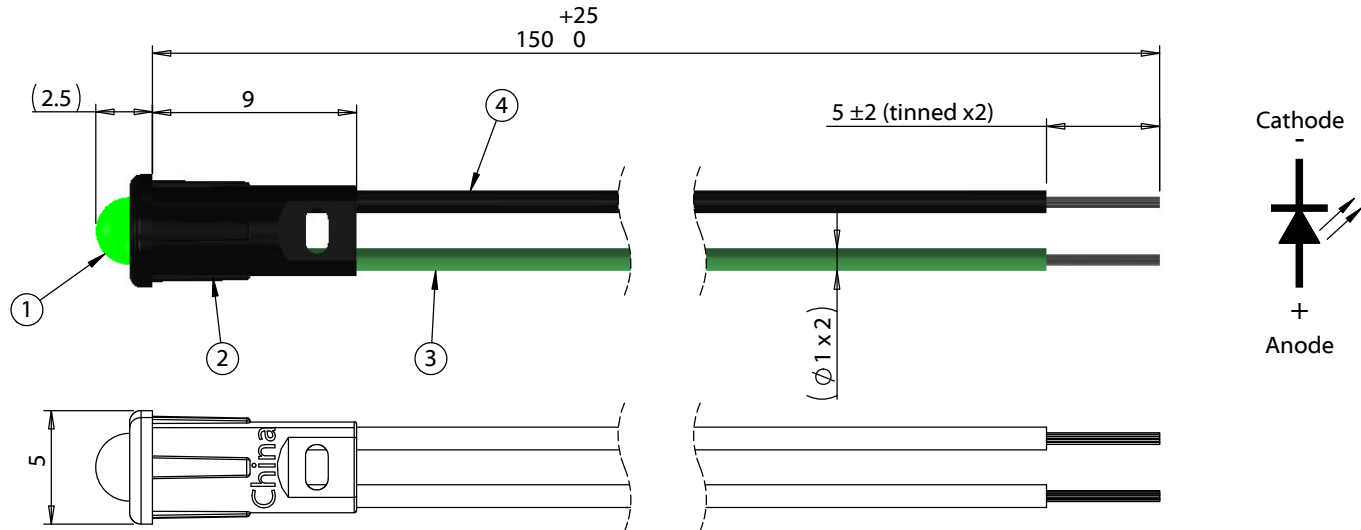
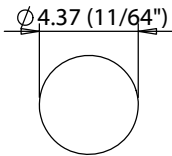

### LED Properties @ 25 °C, 20 mA (IF)

|                            | Min.      | Typ.    | Max.    |
|----------------------------|-----------|---------|---------|
| Forward voltage (VF)       | 2.0 V     | 2.2 V   | 2.4 V   |
| Reverse Current (IR)       | -         | -       | 1 µA    |
| Luminous Intensity (IV)    | 300 mcd   | 400 mcd | 500 mcd |
| Viewing angle (2θ1/2)      | -         | 40°     | -       |
| Forward current (IF)       | -         | -       | 20 mA   |
| Peak forward current (IFP) | -         | -       | 80 mA   |
| Peak wavelength (λP)       | 560 nm    | 570 nm  | 573 nm  |
| Operating temp             | -40~80 °C |         |         |

### Wiring Diagram

| 57-00002 | Wire Color |
|----------|------------|
| +        | Green      |
| -        | Black      |

|           |            |                 |  |   |  |
|-----------|------------|-----------------|--|---|--|
| Revision: | Date:      | Description:    | Prepared:  | Notes:  | <h1>TENSILITY</h1> <p>tel 1.541.323.3228 800 877.670.7118<br/>fax 1.541.323.4202 web tensility.com</p> |
| A         | 10/12/2022 | Initial release | Verified:  | RoHS compliant  |  |
|           |            |                 | Dimensions are in millimeters.<br>Tolerances:<br>X: ± 0.5 mm<br>X.X: ± 0.3 mm<br>X.XX: ± 0.05 mm | Function test: no open, no short circuit, no intermittent                                     |  |
|           |            |                 |  | Description:<br>Cable, 150 mm, green LED 57-00002 to 5 mm tinned, panel mount, 26 AWG UL11028 |  |
|           |            |                 |  | Size: A   | Part number: 12-00002  |
|           |            |                 |  | Scale: 3:1  | Sheet 1 of 1   |